

宁波杰盛模塑工业有限公司  
**JASON MOULD & PLASTIC INDUSTRY CO., LIMITED**  
宁波兆隆模具机械厂  
**NINGBO ZHAOLONG MOULDS MANUFACTURING FACTORY**

地址：宁波市鄞州集士港镇美面桥村西街厂区9号  
ADD: NO. 9 FACTORY ZONE, WEST STREET, MAI MIAN QIAO VILLAGE,  
JISHIGANG, YIN ZHOU DISTRICT, NINGBO CITY, CHINA  
电话 / TEL: +86-574-87623244 +86-574-87830259  
传真 / FAX: +86-574-87623244  
手机 / M. T.: +86-13867876096 13867877718  
E-MAIL: wdjason@gmail.com  
MSN: jason10@live.cn  
HTTP://www.jasonnb.com

[www.jasonnb.com](http://www.jasonnb.com)



Www.saigera.com

**JASON** 杰盛模塑  
**JASON MOULD**  
JASON MOULD & PLASTIC INDUSTRY CO., LIMITED

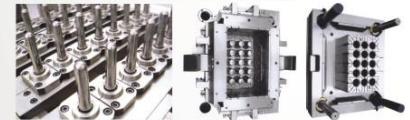

[www.jasonnb.com](http://www.jasonnb.com)

PLASTIC MOULDS



## Company Introduction

## 公司简介

宁波杰盛模塑工业有限公司位于东海之滨的中国宁波，交通十分便捷。公司拥有国际先进的机械加工设备，雄厚的技术力量和优秀的管理模式。为全球用户提供最具竞争力的高品质产品和最满意的服务是我们努力追求的目标。

公司以制造优质的塑料模具为主要产业，引进日本MAKINO的NC加工中心，CNC光学曲线磨，NC电脉冲及德国高精度光学检测仪器等先进的专业设备和优秀模具开发设计团队。与日本多家公司进行技术合作。立志于打造以杰盛为品牌的百年模具品牌。本工厂还配有自己试模车间和塑料制品生产基地。并以此为基础，组建了模具制造工厂，机加工制造工厂，广告策划公司和销售代理公司。形成生产管理，市场定位，品牌包装和产品销售四为一体的综合性工贸企业。公司的产品远销世界各地。

我们杰盛人立足市场，关注品质，注重品牌，放眼世界。我们相信成功就在脚下，希望就在前方，让我们为品牌之路而努力奋斗吧！



NINGBO JASON MOULD & PLASTIC INDUSTRY CO., LTD is located in Ningbo China. It has owned the advanced processing machinery, and the high technology and excellent management which make it possible to seek for high qualified products and good service for our customers.

NINGBO JASON MOULD & PLASTIC INDUSTRY CO., LTD is mainly involved in manufacturing plastic mould by importing NC CNC of Japanese MAKINO brand, NC electrical pulse and German optics testing equipment of high precision. Based on cooperation with Japanese companies, the famous Jason brand mould has formed. Our factory also having own testing mold workshop and plastic products making factory. Now my company has become a composite company with mould manufacturing factory, machinery processing factory, advertising company, and sales company as well.

We base ourselves upon domestic and foreign market, and believe Jason brand will be famous in the world.



## DOUBLE COLOR MOLD SERIES 双色模具系列

双色模具设计要求和要点：  
两种塑料材料在同一台注塑机上注塑，分两次成型，但是产品只出模一次的模具。一般这种塑料制品也叫双料注塑，通常由一些特殊完成，且需要我们的双色注塑机。市场上的双色模具已经盛行，并且由于这种工艺可以使产品的外观更加漂亮，易于着色所以不用喷漆，肯定将是市场潮流。

- 特点：  
1. 双色模具需要相配合的注塑机。 2. 多了一个转动机构或上下滑动机构。 3. 前模有区别，后模是一致的。  
4. 注意气缸或其它动力的应用。 5. 精度要求高。

**Double color moulds design and technology required:**  
Double color plastic products are usually produced in one injection molding machine but go through two steps. Usually the technology has been called double material plastic injection moulding, and the whole process should be completed by one double color mould and special double color injection molding machine. The double color mould has been used widely, and will be more and more popular in the future because it can make the products more colorful and don't need to be painted.

- Features:**  
1. double color injection moulding machine is needed 2. rotating system or gliding system in extra  
3. front mould different, back mould same 4. note the cylinder use  
5. precision is highly required

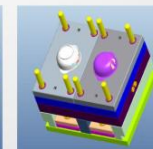
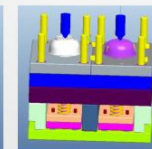
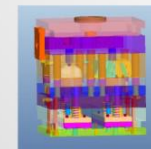
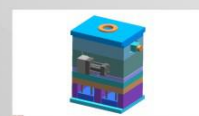
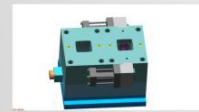
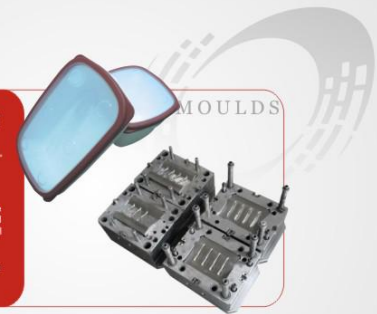

ENGLONG 恩格



**PET PREFORM MOULDS SERIES** PET瓶胚模具系列

**Fitting product feature**

Mould base steel use: DIN 1.2311 with precision grinding machine with each plate thickness tolerance 0.015 mm for a plate size 500x500x40 with HRC 32. Mould spare parts use DIN 1.2344 in D-M-E metric dimension standard; all the moving aera was inserted with durable parts which is interchangeable. Precision temperature controlling and even heating area for hot manifold; Improved the valve gate system with interchangeable and durable melt PET material sealing. Cavity and core steel: StavaxS420 stainless steel, tempered with HRC 55+/-2. Screw neck slide inserted with prehardened Din 1.2316 with HRC 38 to HRC 42.

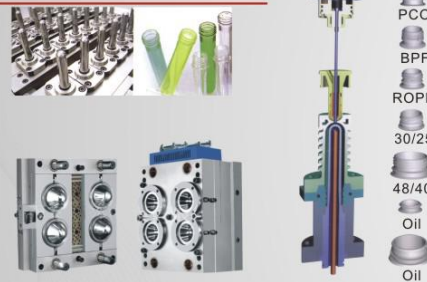
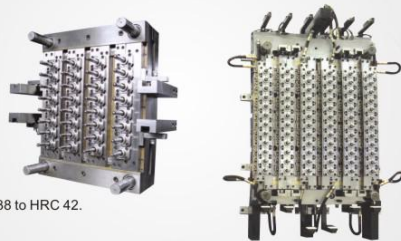

PET瓶胚模具使用性能的好坏，热流通是关键。本厂设计的热流通，吸收了国外的先进技术，结合国内客户的需要，采用免剪浇口设计，热流通喷嘴单独控温。（单独控制的优点以解决在生产过程中所产生问题，例如底部发白、发丝）。模具在全自动条件下生产，无需员工的频繁操作，以减少工人的劳动强度。公司进口多套先进的模具加工设备和各种检测测量仪器，运用专业绘图软件为客户提供设计各种瓶胚、样品的的设计以及制作试验模具。为客户提供专业的技术培训和服务。

JASON COMPANY specialized in manufacturing 24 cavities PET Preform Mould injection molding system, consists of technologists with rich experience, and senior engineers with master's degree and professional in 3D. We invite many technical committee members and senior professors in mould line are as the technical consultants for our company. Various kinds of processing equipment and detection measurement instrument are imported, as well as special drawing soft is applied in designing performs, samples and manufacturing testing mold. We supply special technology training and other good after-sales service.

**CAP MOULDS SERIES** 瓶盖模具系列

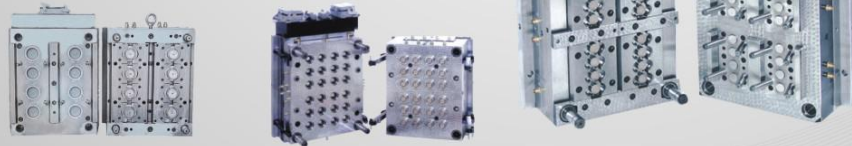

**JASON PACKAGE MOULD - PET PREFORM MOULD SPECIFICATION**

Cavitation	Length(mm)	Width(mm)	Thickness(mm)	Weight(mm)
4	450	240	460	350
6	650	240	460	550
8	560	400	480	800
10	630	400	500	950
12	680	400	500	1050
16	810	400	520	1300
24	670	600	550	1700
32	780	600	560	2000
48	1020	600	580	2700
56	1136	600	580	3050
72	1020	880	600	4200
96	1280	880	660	5700







**Fitting product feature**

Precision parting line in fitting surface and smooth collapsible core parting line in inner surface. Strict dimension control of collapsible core with precision tolerance. Strict wall thickness control and assembling tolerance control. Precision surface finish with smooth ejector pin mark and gate mark. Reasonable surface and runner system. High standard surface polish and finish. Fulfill multi-direction collapsible core system fitting shape.

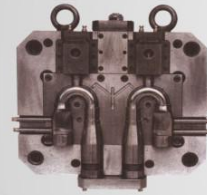

PLAST MOULDS

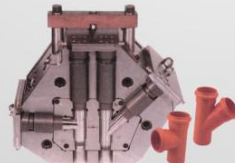
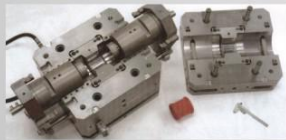
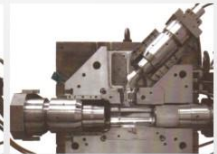
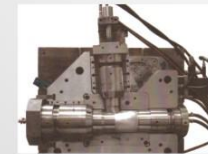
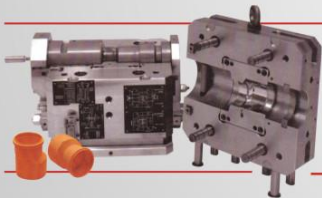
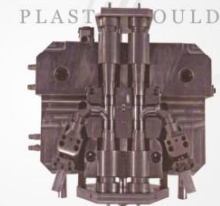

**Fitting product feature**

Precision parting line in fitting surface. Strict dimension control and strict wall thickness control. Precision surface finish with smooth ejector pin mark and gate mark. Tailor made solution for irregular shape fitting system.





### GAS ASSISTANT MOULDS SERIES

### 气辅模具系列



- 气体辅助注塑技术的优点主要有:
1. 解决制件表面缩痕问题, 能够大大提高制件的表面质量。
  2. 局部加气道增厚可增加制件的强度和尺寸稳定性, 并降低制品内应力, 减少翘曲变形。
  3. 节约原材料, 最大可达40%-50%。
  4. 简化制品和模具设计, 降低模具加工难度。
  5. 降低模腔压力, 减小锁模力, 延长模具寿命。
  6. 冷却加快, 生产周期缩短。

气体辅助注塑成型技术与普通注塑成型工艺相比, 有着无可比拟的优势, 被誉为注塑成型工艺的一次革命。在汽车、家具、日用品等行业所有塑料制品领域得到广泛应用。在家电领域, 电视机壳特别是大屏幕彩电壳更是最早采用气体辅助注塑成型技术的产品之一。

#### Gas assistant plastic injection moulding technology advantage:

1. deal with the surface contract mark, able to increase the surface quality of product.
2. extra gas way thickened can optimize the intensity and size stability and decrease the bad inner strength to the product to prevent the shape twist
3. save raw material up to 40%-50%
4. simplify the mould design, decrease the processing difficulty
5. decrease the mould cavity pressure as well as clamping force to extend the lifespan of moulds
6. expedite the cooling and producing cycle

Comparing with the common technology, the Gas assistant plastic injection moulding technology has the unexampled advantage which can be called a revolution of plastic injection moulding. This technology has been used in many plastic products making such as home electrical appliance, autos, furniture, daily used products and so on. In the television shell producing, the gas assistant plastic injection moulding technology has been widely used.



### AUTOMOBILES/MOTORCYCLE MOULDS SERIES

### 汽摩模具系列

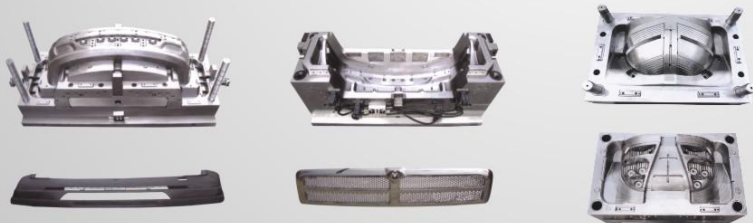

### DAILY MOULDS SERIES

### 日用品模具系列

### PLASTIC MOULDS

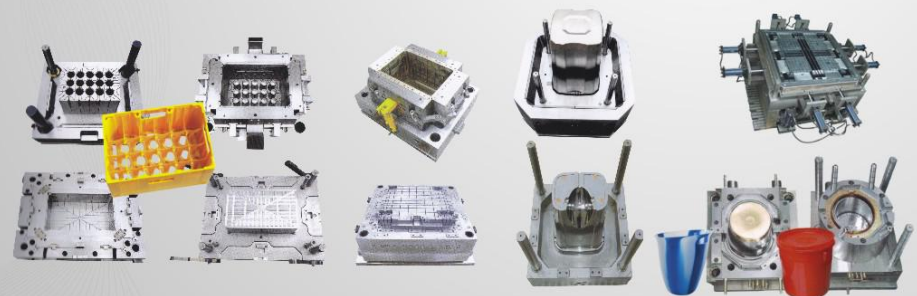
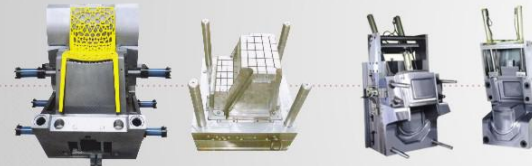



PVC, U-PVC, PPR, PP, PE... Pipe Fitting MOULDS SERIES

管道模具系列

### Fitting product feature

Professional molding shrinkage. Smooth ejector pin mark and gate mark.  
High precision surface finish and parting line. Strict dimension control  
and even wall thickness. Reasonable gate location and runner system.  
Over moulding system for thread insert.



BOTTLE BLOWING MOULDS SERIES 吹瓶模具系列

PLASTIC MOULDS



### Customer comments

客户意见

